



UP6/E-BR Bronze gear pump with electronic pressure sensor + SCS 26 l/min



Quick Overview

Self-priming automatic electric pump, 12/24V, with constant pressure electronic control for the transfer of diesel and oil. Bronze gears, NBR check valve, body and connections in nicked brass, stainless steel shaft. FKM seal and NBR O-rings. Helical bronze gears guarantee constant pressure, heavy duty cycles, less noise and can operate in the absence of liquid. The pumps are supplied with a "High-Speed" setting for Diesel transfer. The integrated SCS control panel allows the switch to the "Low-Speed" mode for the transfer of oil and viscous liquids.

Part n.	Name	Voltage (V)	Consumption (A)	Fuse (A)	Self-priming (m)	Pressure (bar)	Flow rate (l/min)	Ports (BSP)	Hose (mm)	IP Protection	Motor power (W)	Weight (kg)
16472015	UP6/E-BR	12/24	10 / 5	20	2	2,5	26	1/2"	16	67	180	3,7

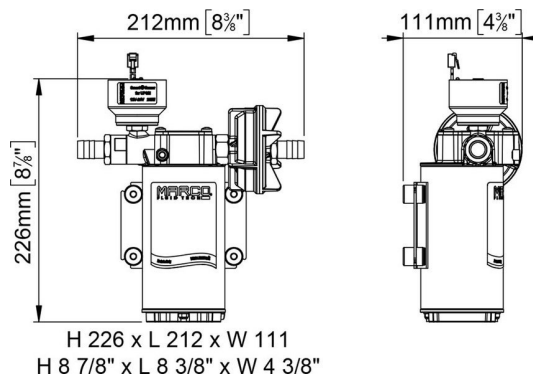



R6400002

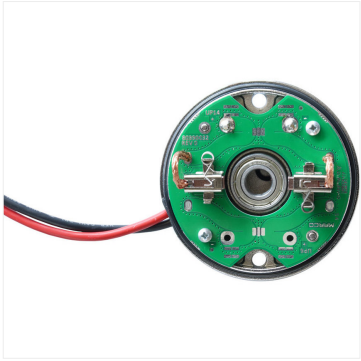

R6400078



R6400103



R6400014



R6400087



R6400015



R6400094



R6400039



R6400099

Accessori



**RJ11 Black cable with coupler for
SCS / PCS**