



Stainless Steel Shower Basket

£112.14

Excl. Tax: £93.45

Product Images





Short Description

316-grade stainless steel shower basket with concealed fixing

Introducing our 316-grade stainless steel shower basket, a perfect blend of style and functionality. Featuring sleek geometric lines and a modern design, and a mirror polished finish. This wall-mounted basket offers a practical, robust storage solution for your shower essentials.

Water drains away efficiently through the open base, making it easy to clean. The stylish holes also allow you to hang gels and soaps. High quality concealed fixings [included] provide a clean, minimalist look. The 230mm width ensures ample space without overcrowding your shower area, making it ideal for compact enclosures.

Crafted entirely from high-quality stainless steel, it promises durability and delivers a sophisticated finish for any bathroom..



Design 500 Design

Description

Product Dimensions

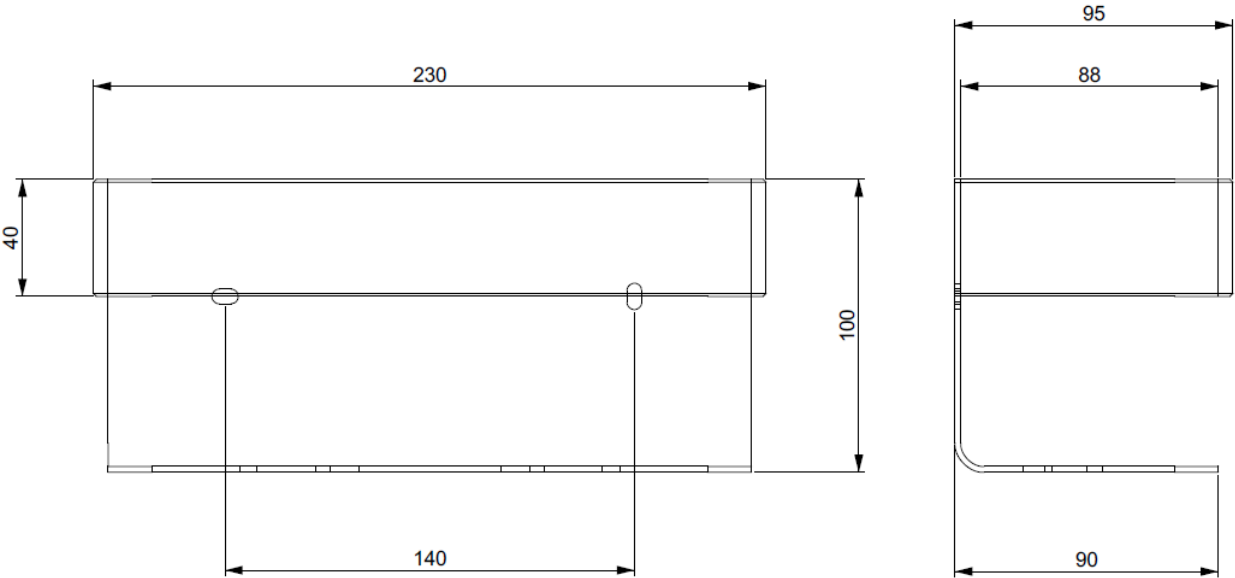

Additional Information

Wall Mounted	Yes
Width (mm)	230.00
Depth (mm)	95.00
Length (mm)	100.00
Weight (kg)	0.400000
Finish	316 Stainless Steel

