



Bollard Cleat

From
£47.46

Excl. Tax: **£39.55**

Product Images



Short Description

Pressure die cast brass bollard in a polished brass or chrome plated finish. Supplied complete with stud fixings.

Description

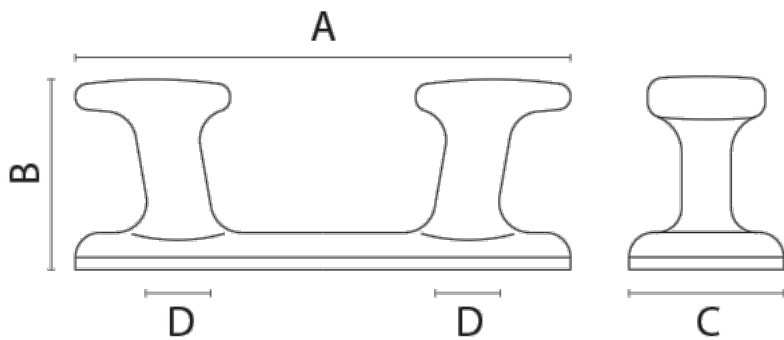

Product Code	A	B	C	D
167A	160	58	50	M10
167B	200	74	65	M12
167C	250	90	80	M14

Additional Information

Manufacturer	Foresti & Suardi
Weight (kg)	0.800000

Product Options

Finish:	Chrome
	Brass
Length (mm):	160
	200
	250

